

ENGLISH
ESPAÑOL



TRUPER®

Manual

Air Texture Gun

3 Output
diameters

Applies for:

| Model | Code |
|----------|-------|
| PITI-687 | 19233 |

PITI-687

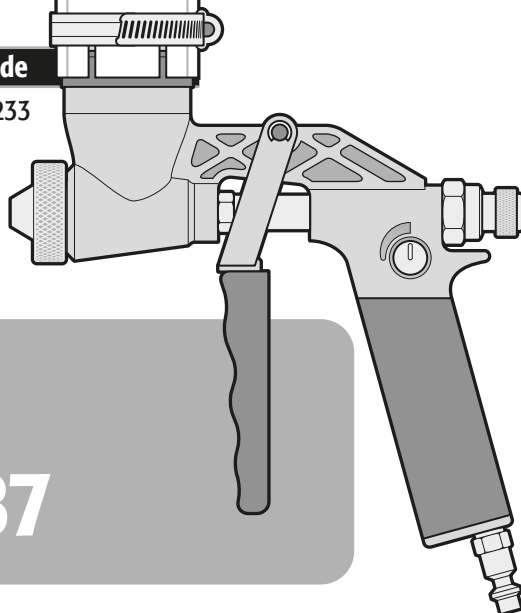

CAUTION



Read the entire manual
before using the tool



| | |
|---|-----------|
| Technical data | 2 |
| Pneumatic Requirements | 2 |
|  Safety Warnings for Using Pneumatic Tools | 3 |
|  Safety Warnings for Using Texture guns. | 4 |
| Parts | 5 |
| Setting Up | 6 |
| Start Up | 7 |
| Maintenance | 8 |
| Troubleshooting | 9 |
| Notes | 10 |

CAUTION

To gain the best performance of the tool, prolong the duty life, make the Warranty valid if necessary, and to avoid hazards of fatal injuries please read and understand this Manual before using the tool.

Keep this manual for future references.

The illustrations in this manual are for reference only. They might be different from the real tool.

Technical data

PITI-687

| | |
|-----------------------|-----------------------|
| Code • | 19233 |
| Description • | Air Texture Gun |
| Hopper Capacity • | 2 GAL |
| Work Pressure • | 40 PSI- 90 PSI |
| Connection Diameter • | 1/4 NPT |
| Air Consumption • | 2.4 - 2.55CFM |
| Nozzle Diameter • | 3/16", 1/4" and 5/16" |

Pneumatic Requirements

- It is recommended to use compressors with at least 3 CV with a 100 liters deposit.
- To carry out the job comfortably use high-pressure hoses with the right length.

 **CAUTION** • Dust and water condensed inside the compressor tank may cause a deficient finish onto the working surface. It is recommended to install a regulating filter between the compressor and the cement plastering machine.

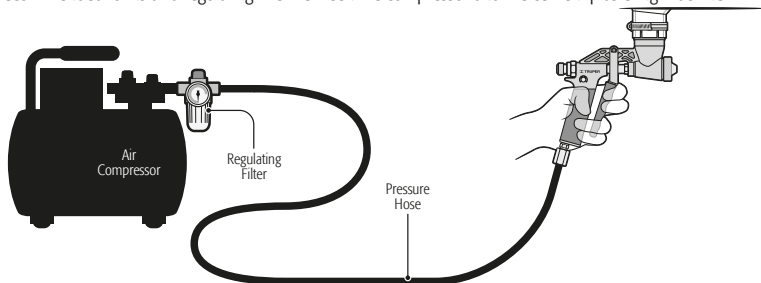

Safety Warnings for Using Pneumatic Tools



Keep your work area clean, tidy and well lit.

CAUTION Cluttered and dark areas can cause accidents.



Never use the tool in explosive environments or in the presence of flammable liquids or with no ventilation.

DANGER Sparks generated by the tool could cause explosion or fire.



Keep children and other people at a safe distance while using the tool.

WARNING Distractions can make lose control and cause accidents.



Avoid making contact with power lines and circuits.

DANGER Place an avoid power lines and circuits especially hidden wiring including grounded objects.



Stay alert, be cautious and use common sense.

CAUTION Familiarity with the use of the tool could distract you while operating it. This can cause accidents.

Do not use the tool if tired or under the influence of drugs, alcohol or medication.

DANGER A moment distraction while using the tool can cause severe personal injury.

Use the tool with all its parts in place and in good repair.

WARNING Failure to comply with this instruction can expose you to severe injury.

Secure and support correctly the work piece .

CAUTION Use vices and a stable work surface.

Never force the tool.

CAUTION Working within the range of the tool design assures a better and safer job.



Store the tool in a safe place away from children reach.

WARNING Pneumatic tools are dangerous in inexperienced hands.



Wear the right clothing.

WARNING Loose clothing, jewelry or long hair can get caught in the moving parts.



Keep hands away from the moving and / or rotating parts.

WARNING Failure to comply with this warning expose you to severe personal injury such as cuts, burns and crushing.



Wear the adequate personal protection equipment.

CAUTION Use of eye protection, dust mask, anti-squid safety shoes, and protection helmet and safety gloves considerably reduce risk of injuries.



Disconnect the air hose from the tool before servicing or changing accessories.

WARNING To prevent the tool from accidentally starting up and cause accidents.

Never use the tool if the switch is not working or if it is not correctly assembled.

WARNING Using the tool in disrepair expose you to severe personal injury. Repair immediately in a **TRUPER** Authorized Service Center.

Do not overreach.

CAUTION Good footing and balance allow having better control on the tool in unexpected situations.

Never pull the air hose.

WARNING Do not use the hose to carry the tool or disconnect it from the air supply. Damaged or tangled hoses may burst and shoot residues towards the operator.

Prevent accidentally starting the tool.

WARNING Double check the air intake is disconnected before lubricating, setting accessories or servicing the tool.



Remove all the vices before starting the tool.

DANGER Additional tools, or vices set onto a rotating piece in the tool may cause severe personal injury.

Service the tool and verify it is in excellent conditions before using it.

CAUTION Double-check carefully all the mobile parts, alignment and assembly. Do this inspection regularly. Look for any damaged element or malfunctioning part. Replace immediately in a **TRUPER** Authorized Service Center.



Accessories.

CAUTION Use only accessories or spare parts indicated in this Manual or certified by **TRUPER**.

Never leave the tool running unattended.

CAUTION Disconnect the tool from the air supply after operating and before storing in a safe place to prevent accidents.

Substances and materials

⚠ CAUTION • The equipment's design is for applying covering materials such as paint, varnish, enamel, etc., with an ignition point not lower to 70 °F. See the product label in the can or container.

⚠ WARNING • Do not spray substances with which you are not familiar and not know the potential dangers.

⚠ WARNING • Do not spray flammable substances. • Be careful of the dangers the sprayed substances originate. Read the text and information in the cans and containers or the manufacturer specifications.

While Operating the Equipment

⚠ CAUTION • Never aim the texture gun to paint against yourself, third parties or animals.

• Double check the equipment is not absorbing any solvent vapor.

⚠ CAUTION • If pausing during the applying process do not set aside the plastering machine. Support it by the hook so it stays in a vertical position.

Before Operating the Equipment

⚠ CAUTION • The equipment shall not be used in closed spaces or in explosive environments. • If working outside, consider the wind direction. Wind can carry the covering over long distances and cause damage as well as making the job very difficult.

⚠ CAUTION • If working indoors, verify there is adequate ventilation.

⚠ WARNING • Your work area shall be free of any ignition source. Do not smoke during spraying or near the work area.

⚠ CAUTION • Wear a mask and safety eyeglasses when spraying to prevent injuries in lungs and eyes.

• It is advisable to wear gloves and an overall to protect hands and clothes from the product you are applying.



After Operating the Equipment

⚠ WARNING • When finishing the job, clean the texture gun thoroughly to eliminate any product residues. Product accumulations may damage the texture gun and nullify the Warranty.

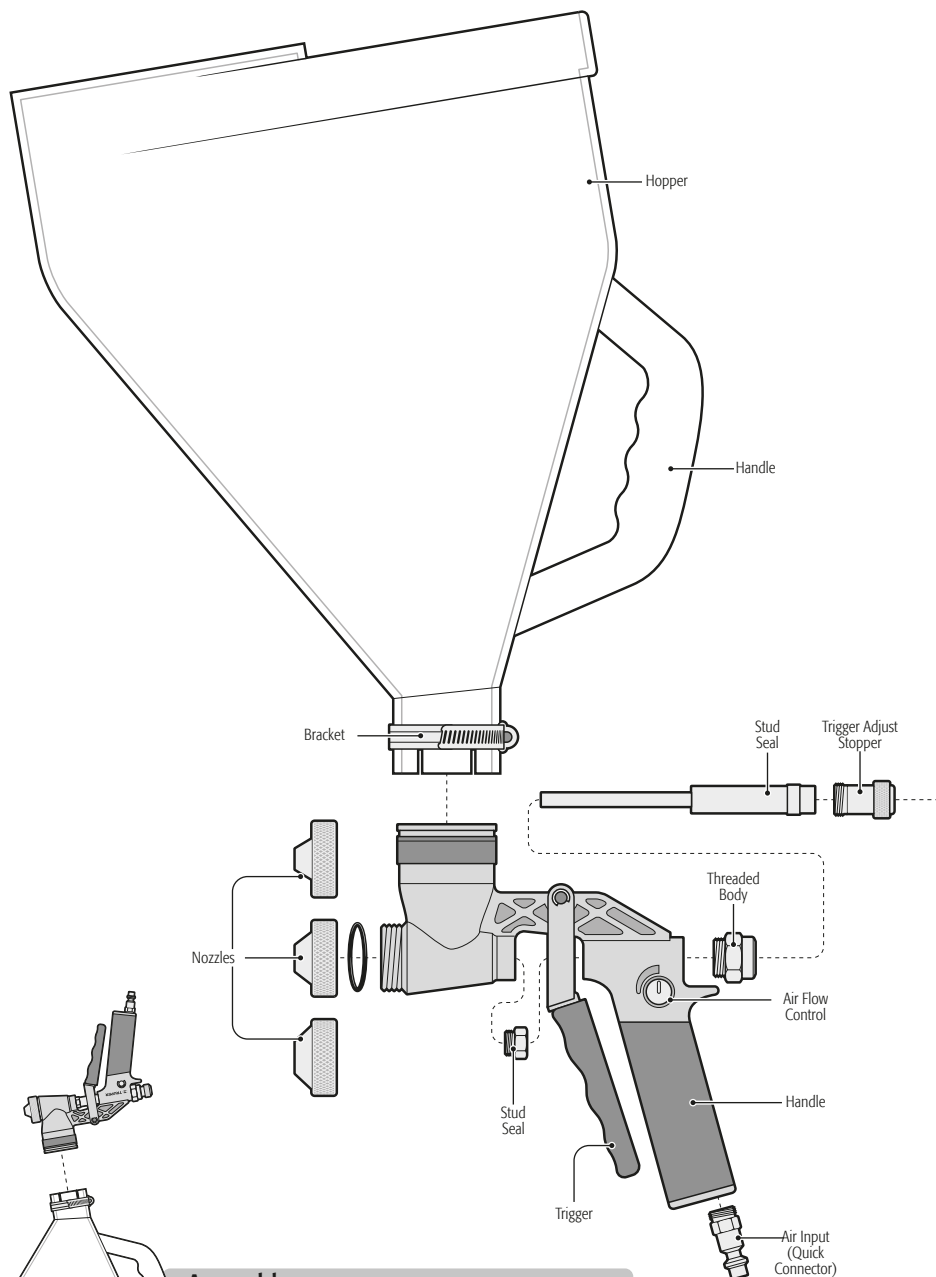

Assembly

Rest the hopper in an inverted position onto a table or the floor. Set the bracket in the hopper neck. Turn the texture gun so that the handle sits in the same side than the hopper handle. Push it downwards until the material feed is well set in the hopper. Tighten the bracket. Lastly, connect the compressor hose to the fast connection in the texture gun base.

- This texture gun is a precision tool designed to give texture to walls and ceilings. Manufactured to offer long-term use with minimum maintenance. To give texture to your space you need only the texture gun, an air compressor and texturizing material.
- Use the tool correctly following this manual to assure your texture gun performs well and is profitable. Do not neglect oiling and cleaning it thoroughly after each use.

Air Compressor

- Use a compressor that works with 40 PSI and 90 PSI.
- If the compressor is adjusted to deliver low pressure, the texture gun will apply a thicker texture. If adjusted for high pressure, the texture will be finer.
- Air supply shall be uniform or the texture patter will be deficient.
- Test the mix using panels made of plaster, plywood or cardboard.
- The desired texture will depend upon the last adjustments to the plaster machine (trigger run).
- The following table shows the basic parameters to prepare the type of spray.

Materials

- There are plenty manufacturers of texturizing materials. It is important to follow the manufacturer instructions when preparing the materials. The texture gun can apply practically, any texturizing material that can be fed and atomized through gravity.
- When using all-purpose sealing compound or light finish compound, dilute material with approximately 1/3 gallon water per each gallon of material. After mixing the texture material it shall get a thick paint or diluted paste thickness.
- Verify the manufacturer instructions if there is compatibility contraindication between the material and the aluminum guns.
- Never operate the texture gun with a dry or too pasty mix. It damages the machine.
- If the paste turns pasty, add more water to get a more liquid consistency.
- To increase the useful life of the plastering machine, DO NOT leave the mix inside the machine or the hopper for long periods of time. Clean thoroughly with water after each use.
- Do not fill the hopper with more than 2 gallons of mix. Otherwise it may spill out and cause an accident.

| Texture Pattern | Mix Thickness | Nozzle | Compressor Pressure PSI | Trigger Run |
|-----------------------|-----------------------------|--------|-------------------------|--------------|
| Dotted- Light | Thick paint | Small | 23 -25 | 1/3 |
| Rough Surface | Thick paint | Medium | 20 -23 | 1/2 |
| Dotted - Intermediate | Thick paint | Medium | 17 - 20 | 2/3 |
| Dotted - Rough | Thin Mortar | Large | 10 - 15 | Complete Run |
| Acoustic | Manufacturer Specifications | Large | 17 - 20 | |

Spraying Nozzles

- Use smaller nozzles to get fine textures and larger nozzles to get thicker textures. Always use a tip for large spray when applying acoustic material.

Plastering Materials Volume

- The trigger position will establish the volume of material the texture gun will spray and expel. Upon pushing the trigger, the air flow delivered through the compressor opens. The more the trigger is pushed, the more material will be expelled producing a thicker pattern.
- After coupling the nozzle and adjusting the compressor pressure, adjust the trigger run. Turn the knob **(A)** to the right to shorten the trigger run. Turn left to lengthen the trigger run.

Starting

- Turn the compressor on.
- Press the trigger **(B)** to open the air flow and start suctioning the product from the hopper. Point the texture gun toward a piece of cardboard until the product starts spraying.
- Release the trigger to stop the spray flow.

Spraying Techniques

- To get an excellent job keep the texture gun 27" to 39" away from the surface to be sprayed.
- Always spray from the floor to the ceiling and back from the ceiling to the floor. Never stop in the middle of the wall.
- Maintenance, cleaning and lubrication after each use is very important.
- Always test the spray pattern before applying on the work surface. We recommend spraying on a plywood or cardboard sheet to check out the results.
- If using the texture gun for the first time, we suggest experimenting different set ups changing the trigger pressure and pneumatic pressure, depending upon the material and pattern needed.
- If upon spraying onto the wall, the result is not adequate, remove immediately (while wet) using a spatula and start all over again.
- To get a good finish it is important to prepare the surface to be sprayed. Reduce thickness to get the right viscosity before applying.
- Double check the surface to be sprayed is free of dust, dirt and grease.
- Make sure to cover the areas you will not be spraying using adhesive tape, paper and / or plastic.

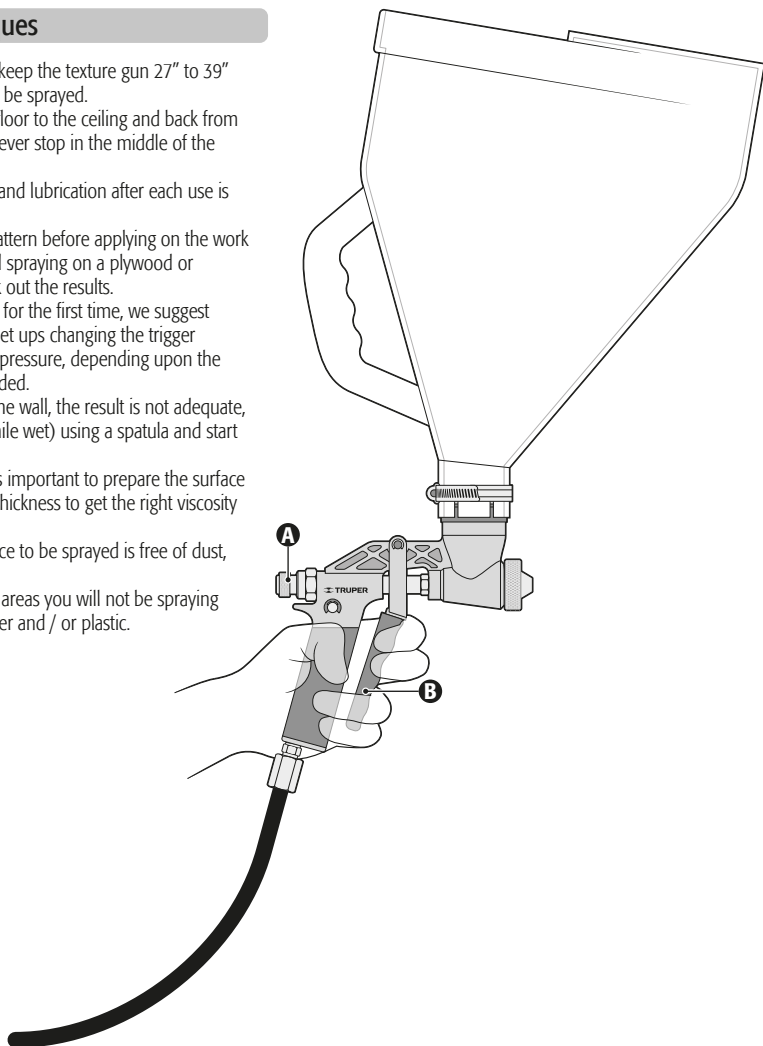

Cleansing and Care

- It is very important to clean the texture gun thoroughly after each use.

⚠ WARNING • Cleaning the machine carelessly will, in the long run, lead to malfunctioning and will nullify the Warranty.

⚠ WARNING • Never immerse the texture gun in solvent. The washers may be damaged.

- Wear gloves and safety glasses.
 - Disconnect the hose from the plastering machine.
- Remove nozzle and hopper.
- Clean the hopper and the texture gun body with a cloth damp with water.
 - For a deeper cleansing, disassemble the rest of the components. Clean with a brush and water, or air-blow the texture gun to eliminate any texture material or water inside the components.
 - Before assembling back, apply a small amount of grease (grease for wheel bearings or lithium based) in all the O-rings. Slide the pneumatic stud in the texture gun from back side of the machine and set the knobs in each of their positions.
 - Use care with the O-rings when reassembling the pneumatic stud. The O-rings may get cut in the threads or rip inside the texture gun inside chamber wall. Set the adequate nozzle.
 - Rest the machine in an inverted position and place 5 to 10 drops low viscosity and domestic use oil in the fast connection. This will make the oil lubricate the pneumatic stud and the O-rings. After lubricating with oil, press the trigger a couple of times.
 - Connect back the compressor hose and purge using water to remove all the remaining texture material.

| Problem | Cause | Solution |
|---|--|--|
| Air flows continuously through the plastering machine. | <ul style="list-style-type: none">• The texture gun internal valve is activated with the trigger and may be stuck or dirty . | <ul style="list-style-type: none">• Disassemble the texture gun to clean and check there are no damaged O-rings. If so, replace. |
| The material is not sprayed correctly. | <ul style="list-style-type: none">• The compressor is too small.• The mix is too thick or is dry. | <ul style="list-style-type: none">• The compressor shall be able to work with pressure between 40 PSI and 90 PSI.• Thin the mix with water. |
| The material is scattered when hitting the wall or ceiling. | <ul style="list-style-type: none">• The pressure is too high. | <ul style="list-style-type: none">• Verify adjustments. See the textures table. If using a tank compressor, regulate the air. |
| The material is not being shoot out through the nozzle. | <ul style="list-style-type: none">• The material was not prepared right. | <ul style="list-style-type: none">• Check the mix preparation procedure. |

